

ITEM	PART NUMBER
A	320-10260
B	14963285
C	14947663
D	580-10244
E	BRA156512

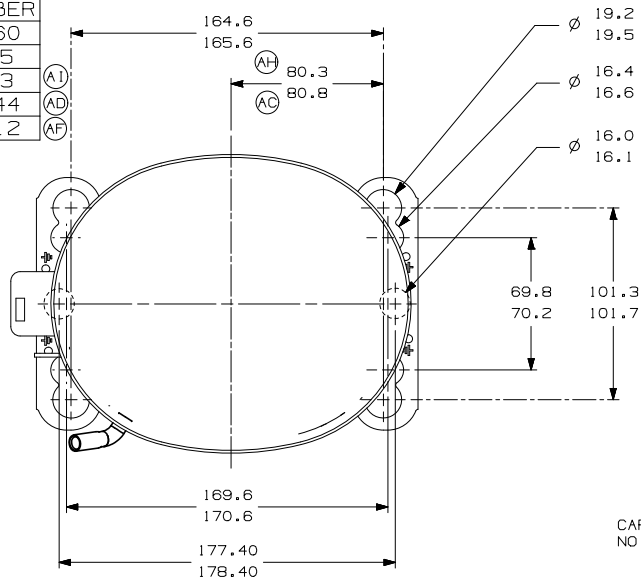

-AUXILIARY VIEW-
FASTENING DIMENSIONS

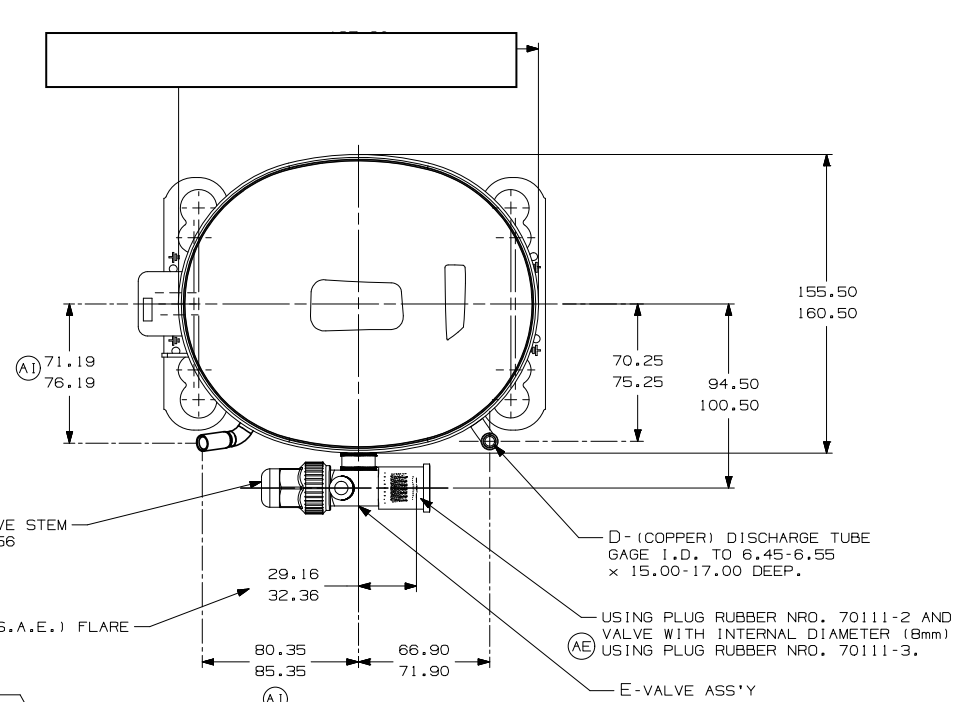

C - (COPPER) PROCESS TUBE
GAGE I.D. TO 6.45-6.55
x 15.00-17.00 DEEP.
THIS TUBE MUST BE SEALED
AND WELDED WITH PHOSCOPPER
IN THE FINAL AFTER THE
DEHYDRATION PROCESS.

SEALING COVER ASS'Y
NO. 14954368

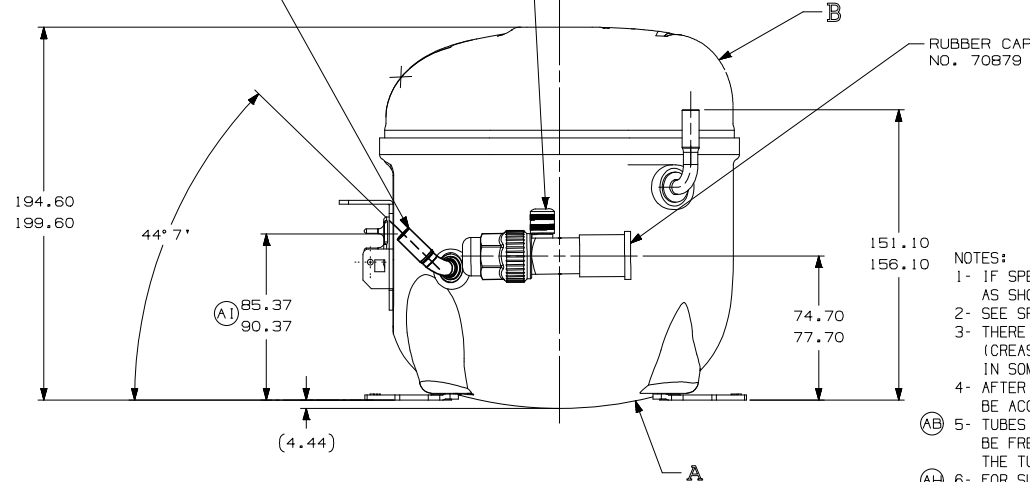
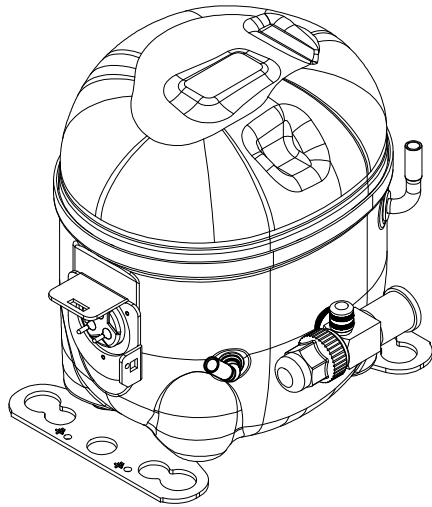

NOTES:

- 1- IF SPECIFIED IN BM, ASSEMBLE PARTS AS SHOWN.
- 2- SEE SPEC. "A-B" & A-C FOR PROCESS.
- 3- THERE CAN BE NO CREASES IN THE TUBES. (CREASES ARE SIGNS OR MARKS THAT ARE IN SOMETHING THAT BENDS)
- 4- AFTER THE FOLDS IN THE TUBES, CANNOT BE ACCELERATED TO AREA EXCEEDING 30%.
- 5- TUBES OF SUCTION, DISCHARGE AND PROCESS MUST BE FREE OF INK ON 15.8mm (5/8") FROM TOP OF THE TUBES AS SPEC. T.P.Co. A-B4.
- 6- FOR SUPPLIER ENVIRONMENTAL REGULATORY REQUIREMENTS, SEE TECUMSEH GLOBAL SPEC. 08.

THIRD ANGLE PROJECTION	UNITS: mm	DRAWING SIZE: A2
<small>DO NOT SCALE THIS DRAWING. ALL PARTS AS RECEIVED OR AT COMPRESSOR ASSEMBLY PROMPTLY AFTER SUCH REQUEST IS MADE.</small>		

NAME: SALES COMPRESSOR		PART NO.: DCAE215	
OWN. PAULO	CK. RAMIRO	APR. W. CORREA	SCALE 1:2
DATE 21/08/12	REF.	FAMILY	PAGE 1/1

REV.	DESCRIPTION	DATE	BY	CHK.
B5	ERA 91.60-96.60			
D4	ERA 66.60-91.60			
E5	ERA 72.10-77.10			
FB	ERA 14963573			
A1	ALTERADA MEDIDA (A-02-18) (P. 08-08-19) (MP. 28-03-19) (P. 08-03-18) (P. 03-03-15) (P. 31-01-14) (P. 13-09-13)			
AH	ALTERADA MEDIDA (A-02-18) (P. 08-08-19) (MP. 28-03-19) (P. 08-03-18) (P. 03-03-15) (P. 31-01-14) (P. 13-09-13)			
AG	RETIRODO DETALHE (AREA TSENTA DE PINTURA)			
AF	REVISAO ITEM E (ERA 8831580-2)			
AE	D/3 REVISAO NOTA DO PLUG 70111-2			
AD	F/8 ALTERADO TUBO D (ERA: 14963519)			
AC	F/7 ALTERADA MEDIDA (ERA: 80.3-80.6)			
AB	A2 ADICIONADO NOTA			
AA	LIBERACAO			
LT	LC CHANGE			