

Part No. 90537-30

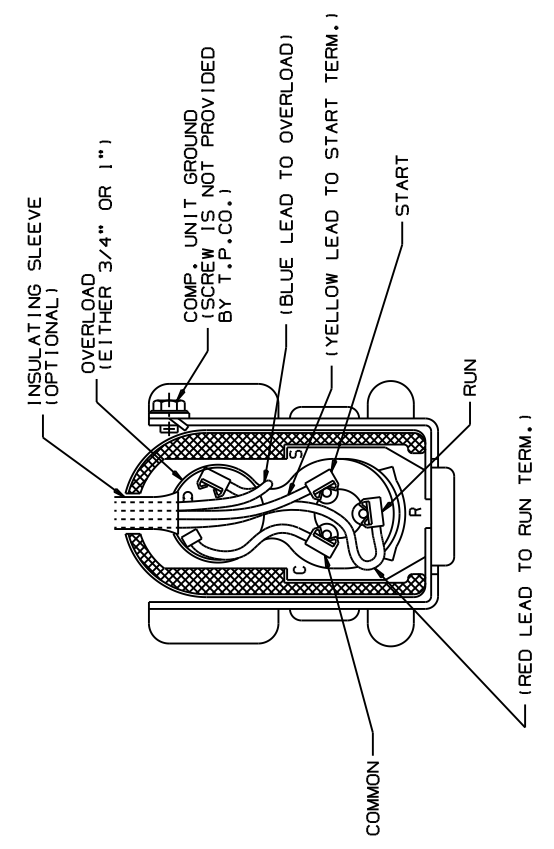

ELECTRICAL HOOK-UP

NOTES  
1. ASSEMBLE PARTS AS SHOWN IS SPECIFIED ON S/W.  
2. OVERLOAD MUST BE WHITE OR RIBBED.  
3. SCREW TERM. RELAY REQUIRED WHEN RELAY IS MOUNTED IN MOUNTING (ALTERNATE).  
ALTERNATE OVERLOAD

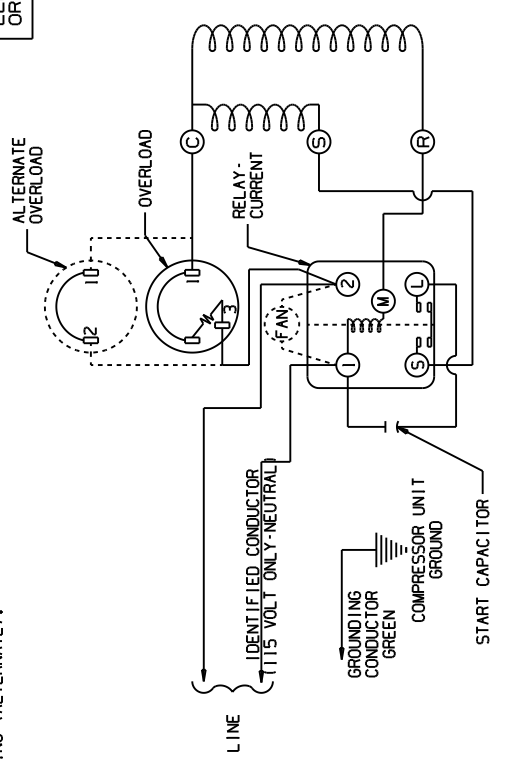

AK-115 OR 230 VOLT - CSIR - CURRENT RELAY

115 OR 230 VOLT SCHEMATIC WIRING DIAGRAM - CSIR - CURRENT RELAY

Part No. 90537-30

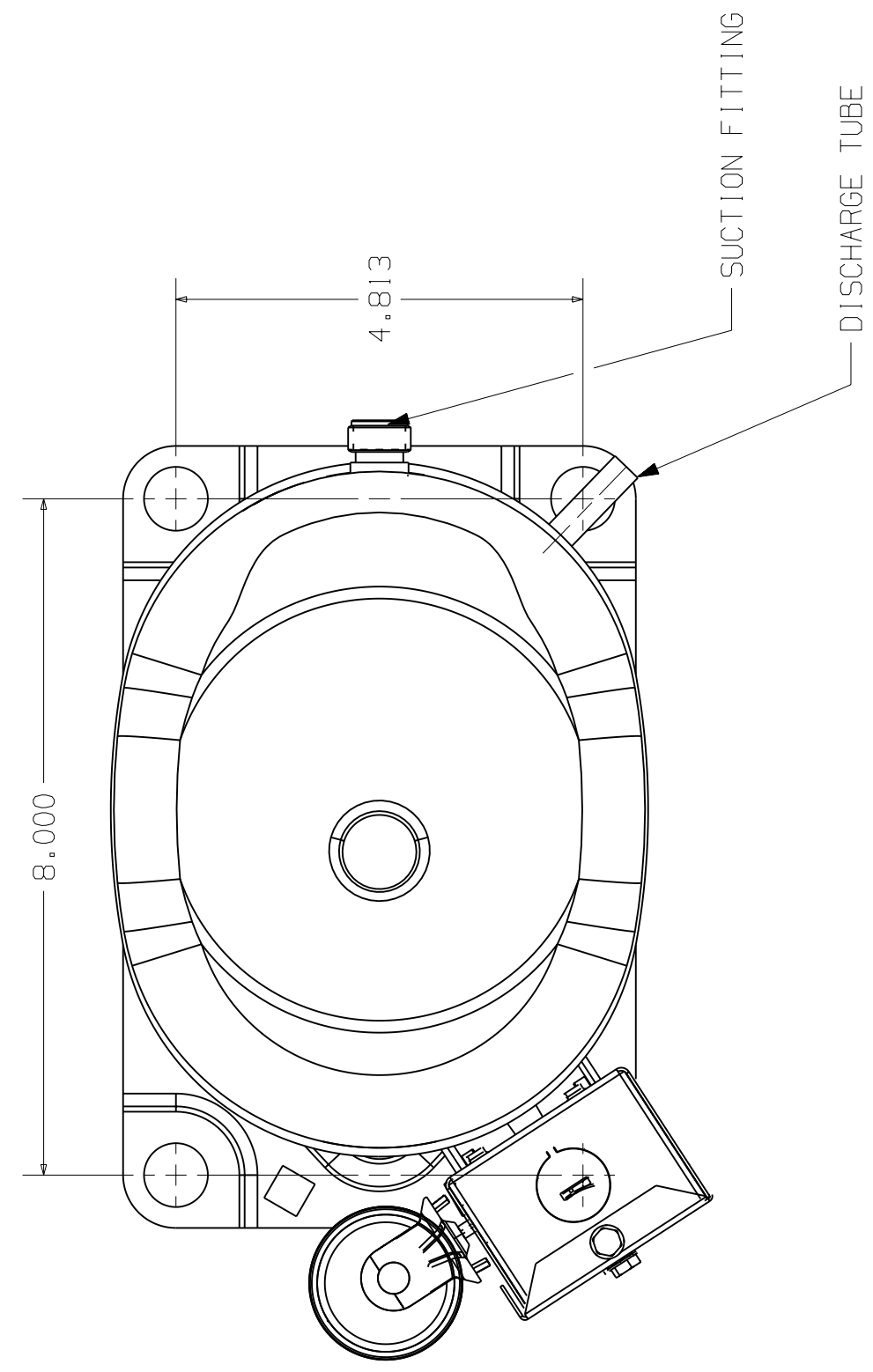

NOTE:  
APPROXIMATE LOCATION OF SUCTION & DISCHARGE TUBES FOR "AK" COMPRESSORS

Ⓐ SIDE A

Ⓐ SIDE B

- NOTE:
1. DUPLEX SIDE A AND B ON 8 1/2 x 11 WHITE PAPER.
  2. REFERENCE DEAK2.
  3. MUST COMPLY WITH T.P.Co. GLOBAL SPEC. 08.

2D, VNX6

O.A. SYMBOLS	
★	= CATEGORY I
▲	= CATEGORY II
■	= CATEGORY III
■	= CATEGORY IV

EC30290 ADDED SIDE A & SIDE B 21 JUN 12 ADDED GLOBAL SPEC. 08	T5	DATE	THIS DRAWING OR PRINT (111) IS THE PROPERTY OF TECUMSEH PRODUCTS COMPANY. IT IS TO BE USED ONLY FOR THE INFORMATION BELONGING TO TECUMSEH. NO INFORMATION CONTAINED HEREIN IS TO BE DISCLOSED OR REPRODUCED IN ANY MANNER WITHOUT THE EXPRESS AND APPROVED WRITTEN AND SPECIALLY APPROVED IN WRITING BY TECUMSEH AND NOT OTHERWISE (111) SHALL BE MADE IN ANY MANNER OR TO ANY EXTENT WITHOUT THE SPECIFIC WRITTEN CONSENT AND (111) SHALL BE RETURNED BY THE RECIPIENT TO TECUMSEH PROMPTLY AFTER SUCH REQUEST IS MADE.	DWG. CODE	NAME	SCALE	THIS PRINT SUPERSEDES ALL PRINTS PRIOR TO
REL	EC14815	—	PROPERTY OF TECUMSEH PRODUCTS COMPANY. IT IS TO BE USED ONLY FOR THE INFORMATION BELONGING TO TECUMSEH. NO INFORMATION CONTAINED HEREIN IS TO BE DISCLOSED OR REPRODUCED IN ANY MANNER WITHOUT THE EXPRESS AND APPROVED WRITTEN AND SPECIALLY APPROVED IN WRITING BY TECUMSEH AND NOT OTHERWISE (111) SHALL BE MADE IN ANY MANNER OR TO ANY EXTENT WITHOUT THE SPECIFIC WRITTEN CONSENT AND (111) SHALL BE RETURNED BY THE RECIPIENT TO TECUMSEH PROMPTLY AFTER SUCH REQUEST IS MADE.	NAME	WIRING DIAGRAM	NONE	
				MATERIAL	TECUMSEH PRODUCTS CO. ANN ARBOR, MICHIGAN		DRAWING NO.
							90537-30